



**9565AB**

**Reductores de 1" a 3/4", con acabado mate**



#### DETALLES DEL PRODUCTO



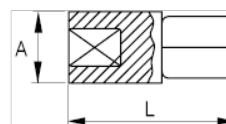

- Acabado mate.
- Acero aleado de alto rendimiento.
- Diseñado para cuadrados de 1" y vasos de 3/4".
- Normas: ISO 1174/3316, DIN 3120/3123 y UNE 16503.



**Follow the Fish!**



## ATRIBUTOS DE PRODUCTO

Producto				<b>A</b>	
<b>9565AB</b>	1"	3/4"	67 mm	48 mm	420 g

